

REVISION HISTORY			
REV	DATE	BY	DESCRIPTION
F	06JUN2022	LSS/RCS	PRN: P2022-1045

E5-M-**H****F**-**YY**1-1**K**
 USE ONLY WHEN H=31 OR H=40

K KEY OPTIONS: 0 - NO KEYS INCLUDED, ORDER SEPARATELY
 1 - 1 KEY PER LOCK, (FLAT KEY)

- H** HEAD STYLE
 00 - SLOTTED
 14 - SQUARE 6mm
 17 - TRIANGLE 6mm
 18 - HEX RECESS 6mm
 30 - WING KNOB
 31 - WING KNOB, KEY LOCKABLE
 40 - KEY LOCKABLE
- F** FINISH
 2 - BRIGHT CHROME PLATE
 5 - BLACK POWDER COATED

YY GRIP
 SEE GRIP TABLE

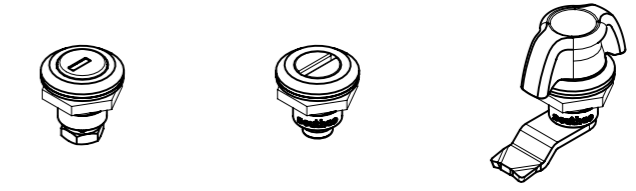

SCALE 1:2

PANEL PREPARATION

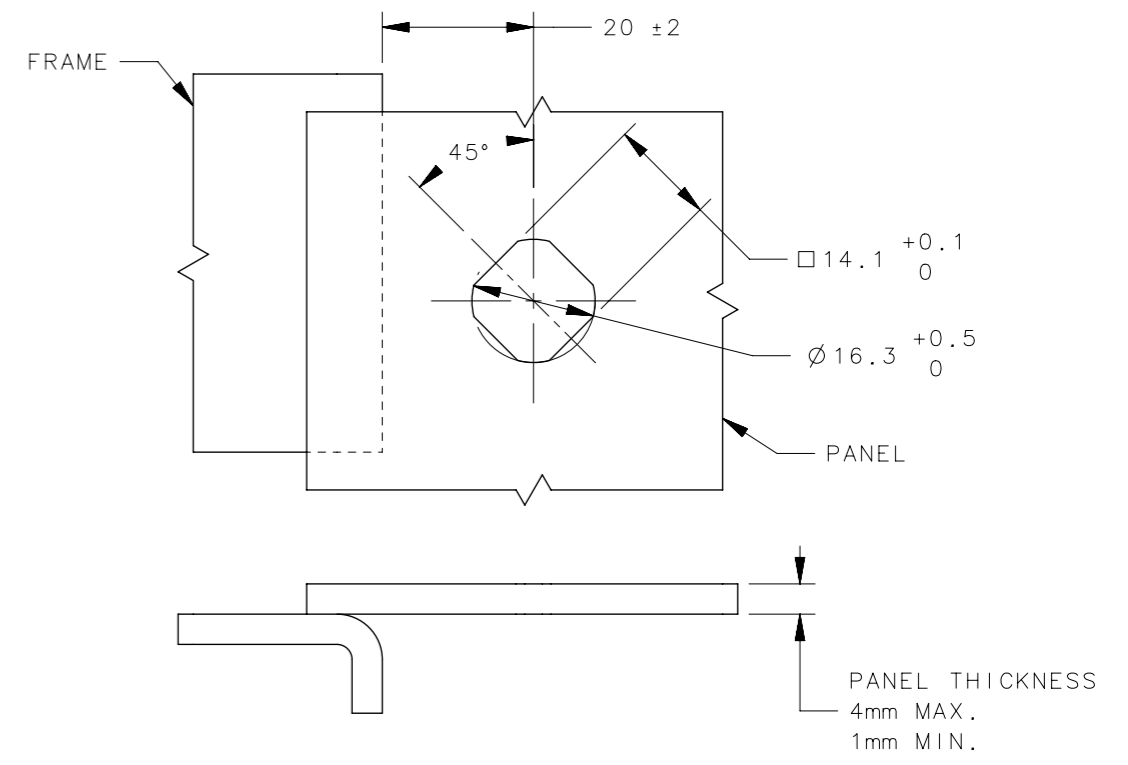

HEAD STYLE **H**

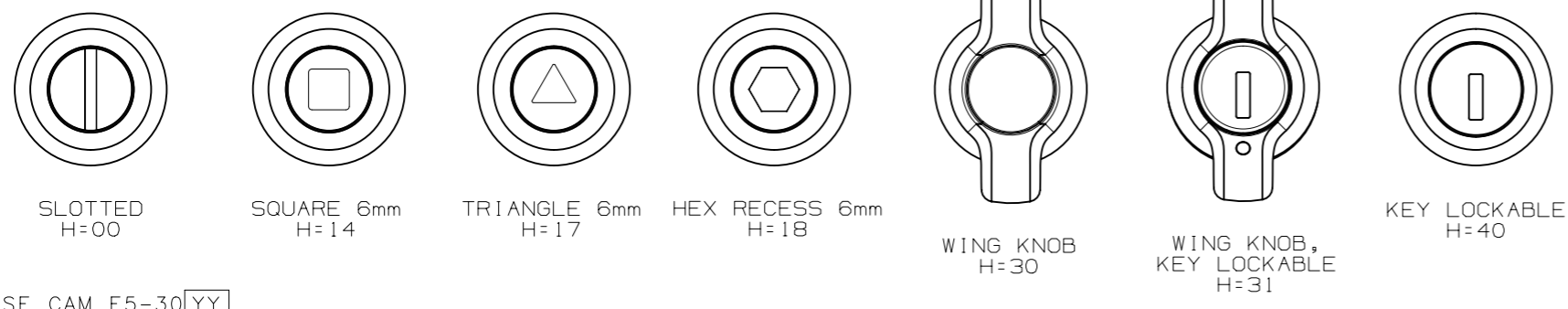

USE CAM E5-30 **YY**

YY GRIP TABLE													
GRIP (mm)	-	4	6	8	10	12	14	16	18	20	22	24	26
YY	UU	05	06	07	08	09	10	11	12	13	14	15	16

UU - CAM NOT SUPPLIED, ORDER SEPARATELY

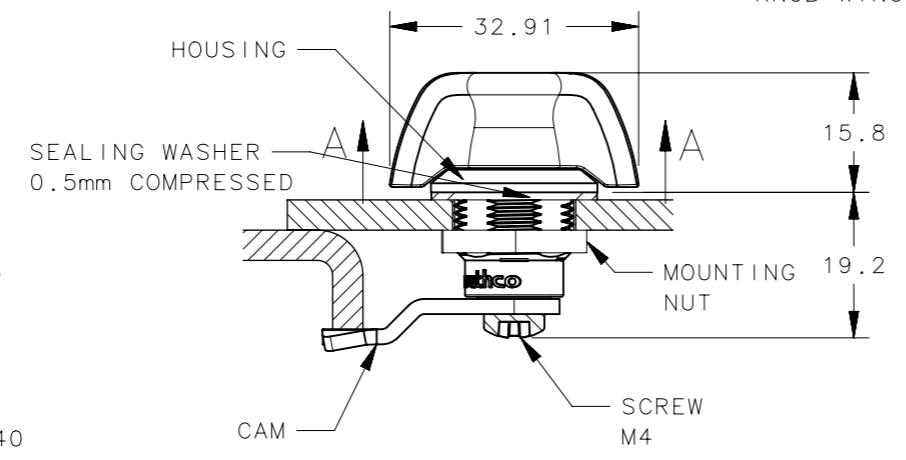
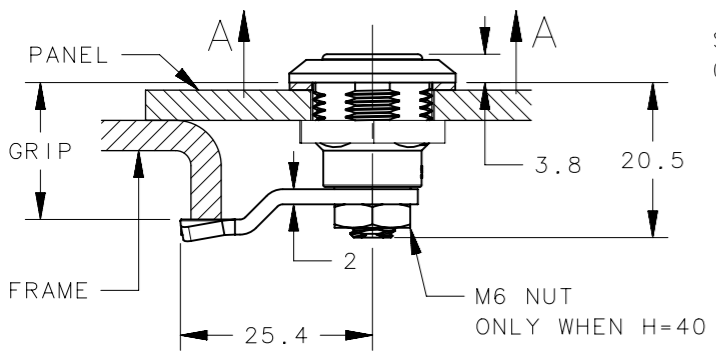
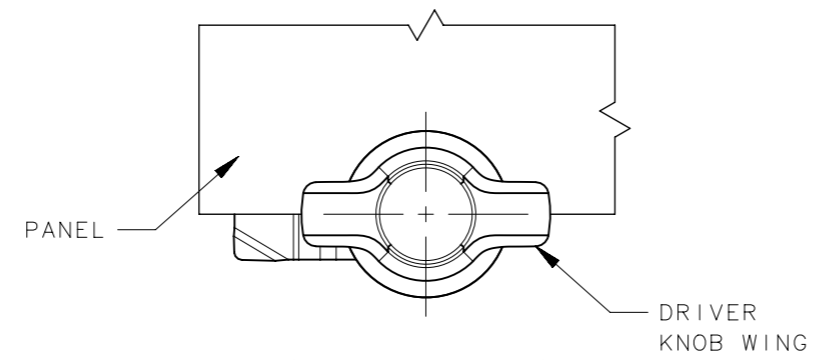
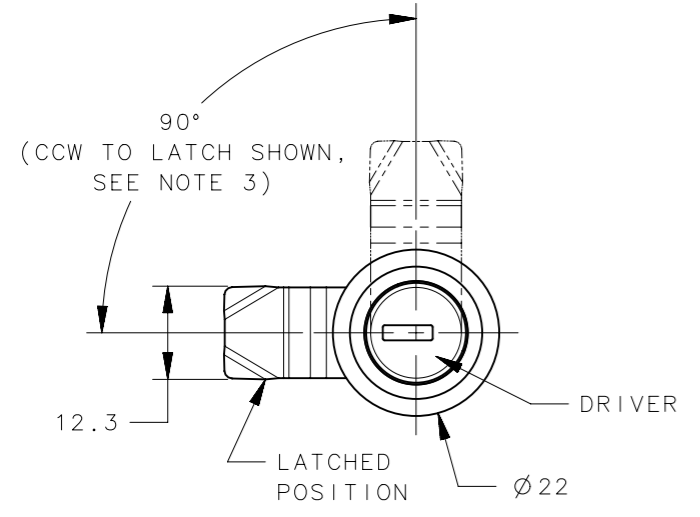

NOTES:

- MATERIAL AND FINISH:
 HOUSING/DRIVER: DIE CASTING ZINC, BLACK POWDER COATED OR CHROME PLATED;
 MOUNTING NUT: DIE CASTING ZINC, ZINC PLATED;
 SEALING WASHER/O-RING: NITRILE, BLACK;
 LOCKPLUG BODY: DIE CASTING ZINC, NATURAL;
 SCALP, DUST COVER, SPRINGS: STAINLESS STEEL, NATURAL;
 SCREW AND CAM NUT: CARBON STEEL, ZINC PLATED
- COSMETIC SPECIFICATION:
 ALL SURFACES ABOVE A-A CONFORM TO CLASS "B" PER SOUTHCO COSMETIC SPECIFICATIONS S-121.
- LATCH CAN BE INSTALLED FOR COUNTER-CLOCKWISE (CCW) OR CLOCKWISE (CW) OPERATION.
- FOR CAM SEE J-E5-30-A AND J-E5-30-B.
- PACKAGING: LATCH, HARDWARE AND SEALING WASHER IS PACKED SEPARATELY, SHIPPED TOGETHER IN BOX. WHEN ORDERING, SPECIFY QUANTITY IN MULTIPLES OF 50 PCS.
- FOR KEY SOLD SEPARATELY SEE J-PK-10 (KEY CODE CH751)

THIRD ANGLE PROJECTION			
MILLIMETERS [IN]			
TOLERANCES UNLESS OTHERWISE NOTED		DESCRIPTION CAM LATCH	
ALL DIMENSIONS WITHOUT TOLERANCES ARE FOR REFERENCE ONLY.		SIZE A3	SYSTEM NX
PER ASME Y14.5M-1994		DWG NO. J-E5-M	DATE 26APR2018
DRAWN BY RM/EC		SCALE 1:1	SHEET 1 OF 2

REVISION HISTORY			
REV	DATE	BY	DESCRIPTION
F	06JUN2022	LSS/RCS	PRN: P2022-1045

INSTALLATION METHOD 1

ONLY APPLIED WHEN LATCH ASSEMBLY IS SUPPLIED WITH CAM.

USE WHEN GRIP FROM PANEL IS EQUAL TO OR EXCEEDS BY 8mm.

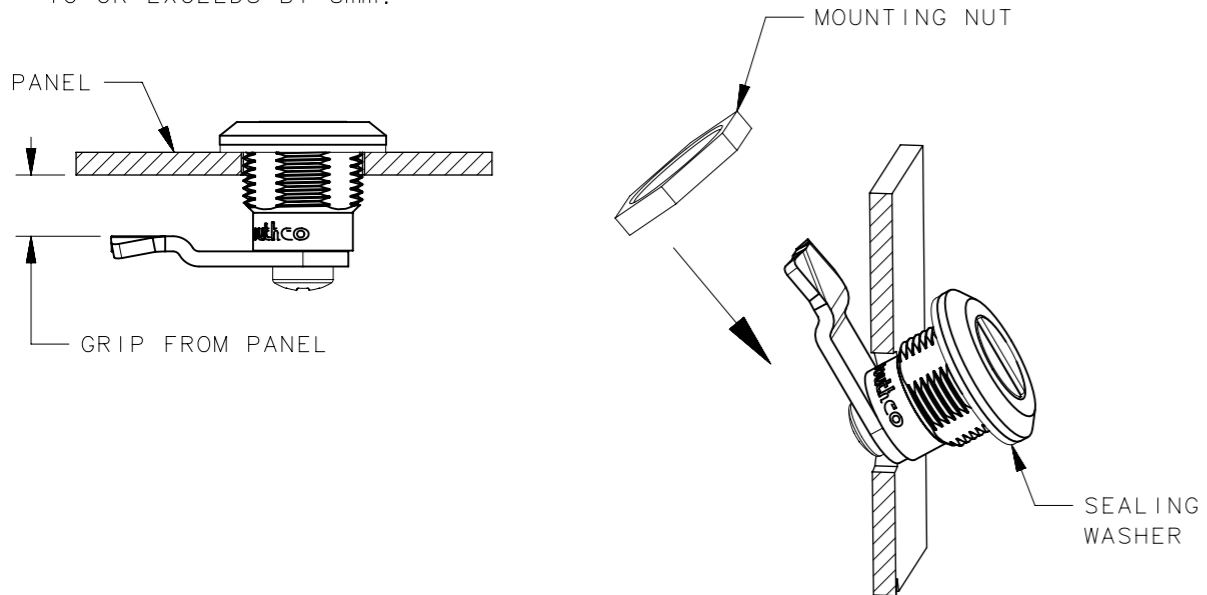

1. PLACE SEALING WASHER ONTO LATCH HOUSING
2. CHECK FOR PROPER ORIENTATION AND OPERATION USING CAM.
3. TILT LATCH THROUGH MOUNTING HOLE.
4. INSTALL MOUNTING NUT AND TIGHTEN TO 5Nm MAX.

INSTALLATION METHOD 2

APPLIED WHEN:
 - LATCH ASSEMBLY IS SUPPLIED WITHOUT CAM. CAM IS ORDERED SEPARATELY.
 - LATCH ASSEMBLY SUPPLIED WITH CAM. REQUIRED WHEN GRIP FROM PANEL DOOR IS LESS THAN 8mm.

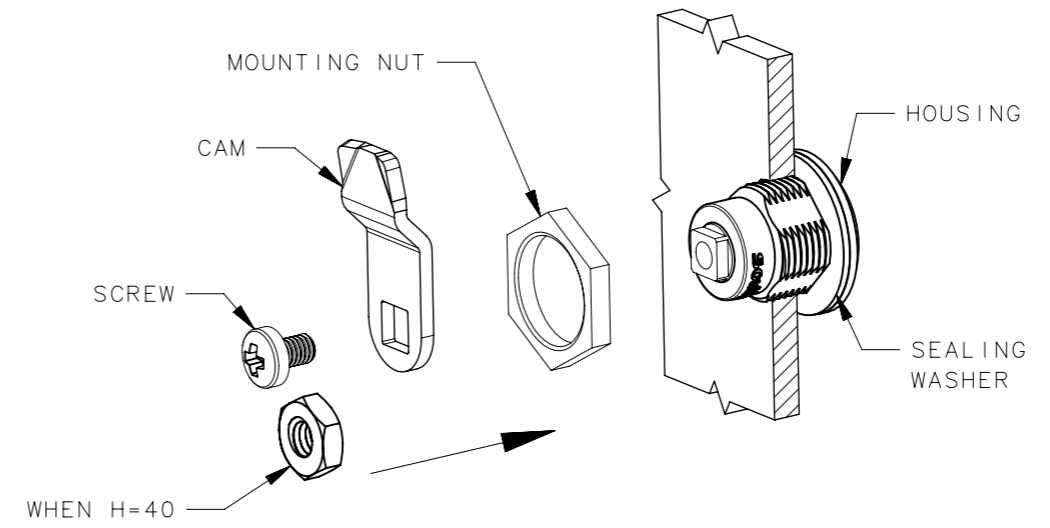

1. REMOVE SCREW AND CAM (IF ORDERED) FROM HOUSING.
2. PLACE SEALING WASHER ONTO LATCH HOUSING AND PLACE THROUGH MOUNTING HOLE.
3. CHECK FOR PROPER ORIENTATION AND OPERATION USING CAM.
4. INSTALL MOUNTING NUT AND TIGHTEN TO 5Nm MAX.
5. ATTACH CAM TO LATCH ASSEMBLY. ASSURE THAT CAM FOLLOW THE ALIGNMENT ACCORDING TO THE POSITION OF DRIVER HEAD.
6. INSTALL SCREW AND TIGHTEN TO 1Nm MAX, OR NUT WHEN H=40, AND TIGHTEN TO 2Nm MAX.

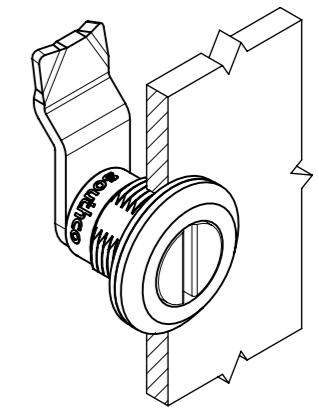

ALIGNMENT OF THE CAM ACCORDING TO DRIVER HEAD (WHEN SUPPLIED WITH CAM)

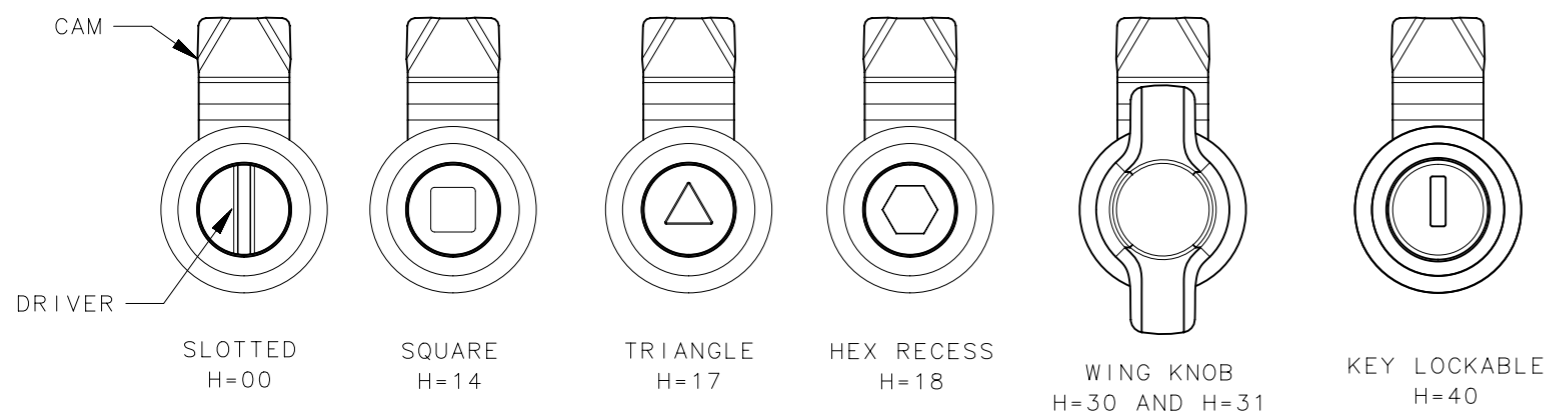

	THIRD ANGLE PROJECTION	 CONNECT • CREATE • INNOVATE		
	MILLIMETERS [IN]			
SURFACE AREA	TOLERANCES UNLESS OTHERWISE NOTED	DESCRIPTION CAM LATCH		
VOLUME	ALL DIMENSIONS WITHOUT TOLERANCES ARE FOR REFERENCE ONLY.	SIZE A3	SYSTEM NX	DWG NO. J-E5-M
PROPRIETARY ITEM EXCEPT FOR USES EXPRESSLY GRANTED IN WRITING, INFORMATION DISCLOSED HEREON IS CONFIDENTIAL AND ALL RIGHTS, PATENT AND OTHERWISE, ARE RESERVED BY SOUTHCO, INC.	PER ASME Y14.5M-1994	DRAWN BY RM/EC	DATE 26APR2018	SCALE 1:1
				SHEET 2 OF 2